

HSF

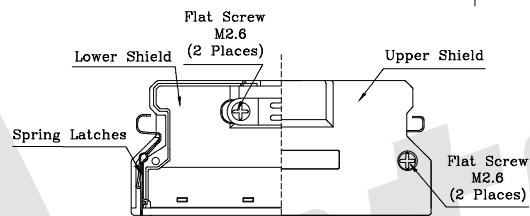

ROHS

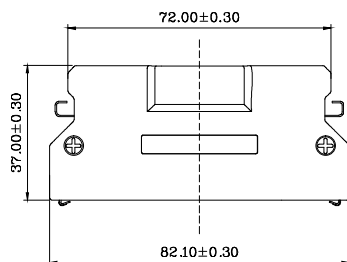
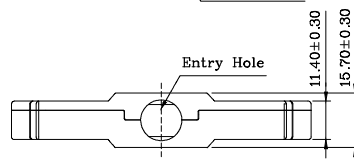
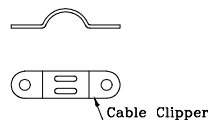
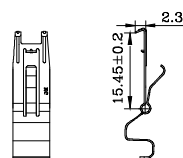

FEATURES:

- Round cable Straight exit
- Strain Relief Straple With Spring latches
- Back shell desing by Die-Cast
- Excellent EMI/RFI protection

MATERIALS:

- Back Shell:Zinc plate nickel over copper
- Spring latches:phosphor bronze over nickel
- Screw:stell nickel plated over copper
- Cable Clipper:stell nickel plated

HPMCS02CNI-100X-S

①②

① ENTRY HOLE SIZES

- 11=Ø11.0 mm
- 14=Ø14.0 mm
- 28=Ø28.0 mm

② Retention Features:

S=Backshell selective Gold Plated

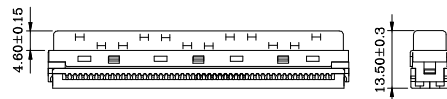
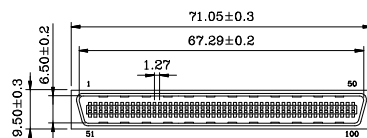
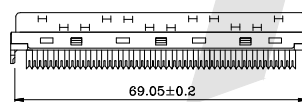
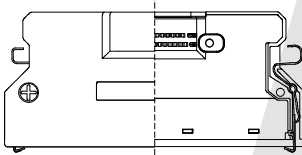
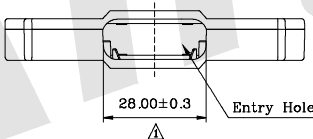

Unless Otherwise specified tolerance
 X. ±0.35 X.XX: ±0.20
 X.X: ±0.25 X.XXX: ±0.15



ANTENK ELECTRONICS CO., LTD
[Http://www.antenk.com](http://www.antenk.com)
 E-mail:sales@antenk.com

SCALE: As Shown UNIT: mm
 DRAW Jack Bao DATE 8/22/2018
 CHECK Bob Yang DATE 8/22/2018

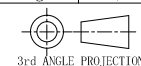

TITLE: 1.27mm Series Shielded Backshell Kits 100P
 Straight Exit With Spring Latches and Connector
 IDC Molded Ribbon Type

DRAWING NO: HPMCS02CNI-100XS

PRODUCT NO: HPMCS02CNI-100XS

REV	DESCRIPTION	DATE
1		
2		
3		
4		
5		